

ADDENDUM REPORT

Fiji: Transport Infrastructure Investment Sector Project

Queens Road Rehabilitation Project (QRRP B): Section 5 – Cross Culvert Slip



ADB Project Number: 48141
ADB Loan Number: 3210-FIJ
WB Project Number: P15002



April 2023

Prepared by Fiji Roads Authority for the Asian Development Bank and World Bank.

This addendum report is a document of the Fiji Roads Authority. The views expressed herein do not necessarily represent those of ADB/WB's Board of Directors, Management, or staff, and may be preliminary in nature.

In preparing any country program or strategy, financing any project, or by making any designation of or reference to a particular territory or geographic area in this document, the ADB/WB does not intend to make any judgments as to the legal or other status of any territory or area.

Contents

1.0 PROJECT OVERVIEW AND REPORT RATIONALE.....	1
2.0 SPECIFIC SITE DESCRIPTION AND PROPOSED WORKS - QRUP B SEC 5 CROSSCULVERT SLIP..	2
Project Name:.....	2
Location:.....	2
Document Purpose.....	2
Proposed Works and type of activities	2
Due Diligence Actions.....	2
Report Conclusions	2
Recommendation	2
Annexure 1: Screening Form	3
Annexure 2: Layout Plan	4
Annexure 3: Assessment Form	5
Annexure 4 : Inspection Photos	6

Abbreviations

ADB	-	Asian Development Bank
CR5	-	China Railway
GOF	-	Government of Fiji
GSA	-	Greater Suva Area
HQ	-	Headquarters
LARDD	-	Land Acquisition and Resettlement Due Diligence
LARF	-	Land Acquisition and Resettlement Framework
QRRP	-	Queens Rd Rehabilitation Project
TIISP	-	Transport Infrastructure Investment Sector Project
WB	-	World Bank

1.0 PROJECT OVERVIEW AND REPORT RATIONALE

1. With loan funding from the Asian Development Bank (ADB) and World Bank (WB), together with funding from the Government of Fiji (GOF), the Fiji Roads Authority are implementing the Transport Infrastructure Investment Sector Project (TIISP). TIISP will improve access to socio-economic opportunities by upgrading and rehabilitating land and maritime transport infrastructure across the Fiji Islands (ADB, 2015a). The overall objectives of the Project are improved access to markets, employment opportunities, and social services. The outcome will be improved safety and resilience of land and maritime transport infrastructure for users of project roads, bridges and rural jetties and wharves
2. One of the sub-projects proposed under this package is the Queens Road Rehabilitation Package B Sub-project. Queens Road Rehabilitation Package B sub-project involves the rehabilitation and upgrade of six sections; namely Sections 4A, 4B, 4C, 5, 7, 8; of sealed road in the Western (Nadroga Province) Divisions with an approximate total length of 20km. The sub- project involves road pavement upgrades, small sections of road widening within the existing road reserve, footpath repairs and footpath installations. The approximate total cost of this sub-project is FJ\$50m.
3. The objective of the sub-project is to lower the overall road maintenance costs, improve the safety of road users (drivers and pedestrians) and improve the travel comfort of road users. Other outcomes expected from the sub- project will be lower road user costs through reduced damage to vehicles. This will be achieved by rehabilitating the existing road pavements that have reached the end of their serviceable life.
4. While a Queens Road Rehabilitation Project (QRRP) B Land Acquisition and Resettlement Due Diligence Report was prepared by the Fiji Roads Authority (FRA) in 2019, FRA has had several design changes in particular an urgent need to replace a cross – culvert slip in Section 5. Therefore, an addendum report for QRRP B Section 5 is required. This action is in keeping with the social safeguards policy outlined within the Project's Land Acquisition and Resettlement Framework.
7. The findings of this Addendum report for Section 5 cross-culvert slip verifies that no land acquisition and resettlement impacts will occur. No temporary or permanent economic or physical displacement will be required for the completion of physical works. Furthermore, physical works will not block access to the neighboring villages along the proposed area as a Traffic Management Plan will be tailored to allow continued and safe access for them.
8. This Addendum report to Land Acquisition and Resettlement Due Diligence (LARDD) Report has been prepared for Queens Road Rehabilitation Project (QRRP) B: – Section 5 Cross culvert slip and submitted to the Asian Development Bank (ADB) and World Bank (WB) as a required level of Due Diligence. It also confirms the adherence to the Land Acquisition and Resettlement Framework (LARF, 2016) that has been prepared for the Project (ADB, 2015b); and aims to receive an approval to “No Objection” to construct.

2.0 SPECIFIC SITE DESCRIPTION AND PROPOSED WORKS - QRUP B SEC 5 CROSSCULVERT SLIP

Project Name: Queens Road Upgrading Project – Package B

Location: Queens Road Section 5, approximately within 500 meters from Navutu Village Junction, Province of Nadroga, Western Division of Vitilevu.

Document Purpose: Screening and verification for social Impacts or Displacements and advice accordingly.

Proposed Works and type of activities: Contractor intends to replace full length of the cross culvert.

Due Diligence Actions:

DATE	EVENT	OUTCOME	SUPPORTING DOCUMENTS
17 /03/ 2023	Land Ownership Searches	Confirmed that the area of construction is within the Road reserve.	Copy of Layout Plan annexed.
17/03/2023	Field Inspections / Site Verification	<ul style="list-style-type: none">• Confirm that there will be no social impacts nor displacement.• Confirm maps and photos taken earlier as per Report• Only a few trees and shrubs of evasive species located with road reserve will undergo normal road cleaning procedures	Forms and related photos are Annexed.
22/03/2023	Precautionary Measures	<ul style="list-style-type: none">• Only marked out trees of evasive species will be removed and FRA Western Officer will be present to supervise.• Contractor will be required to provide a Traffic Management Plan and plan to control movements during active works.	Contractor will submit as soon as Approval is sorted.

Report Conclusions:

Screening confirmed no land acquisition nor resettlement required as per 2019 QRUP LARDD Report.

Recommendation:

No objection to the contractor to proceed on the basis of social safeguards.

Annexure 1: Screening Form



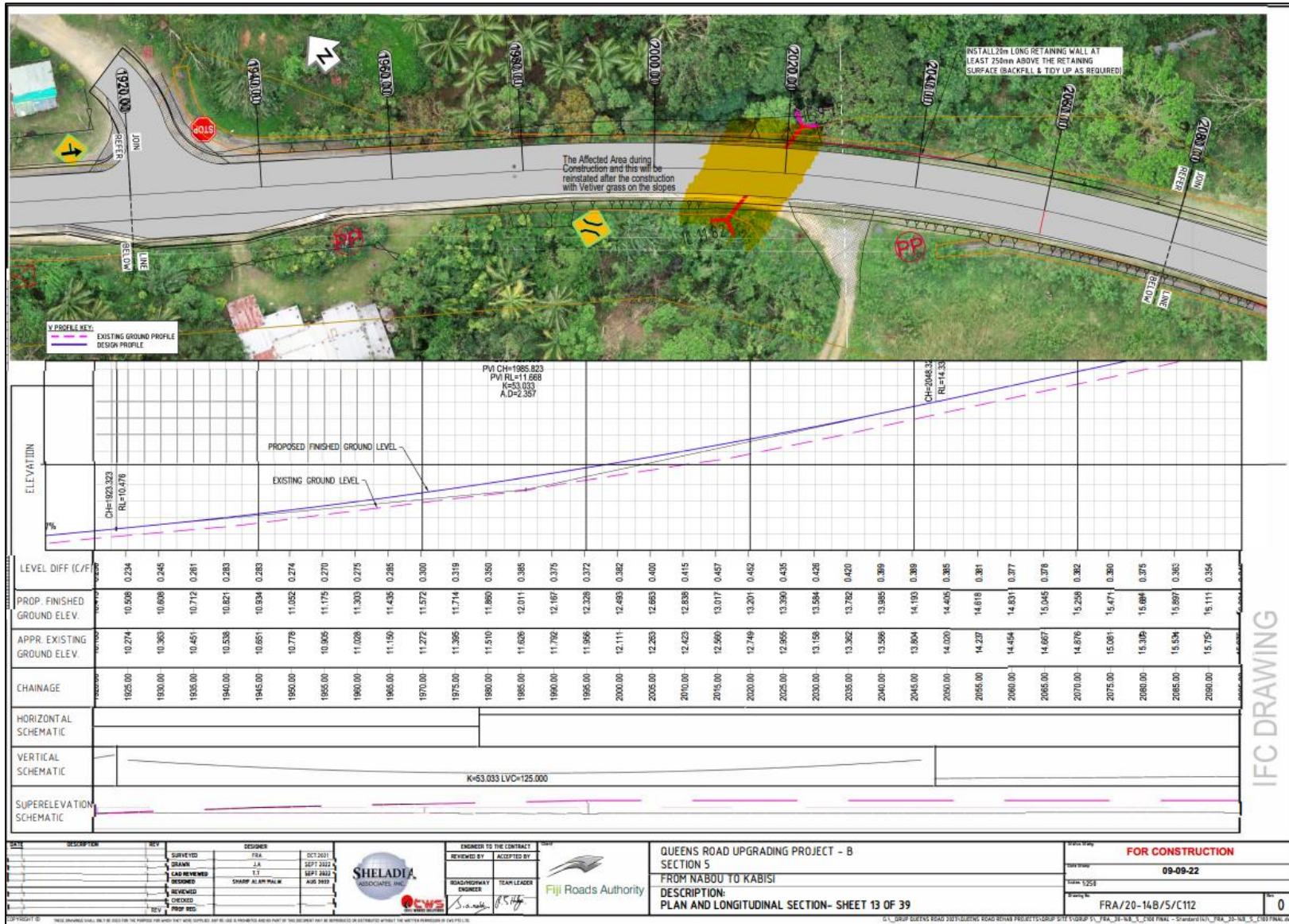

Project Title: <u>Fiji: Transport Infrastructure Investment Project</u>		Loan No: <u>ADB 3210-FJ</u>		
Subproject: Queens Road Upgrading Project – Package B – Section 5 Cross Culvert Slip				Date: 17/03/2023
Location and impact area: <u>approximately within 500 meters from Navutu Village Junction, Province of Nadroga, Western Division of Vitilevu</u>				
Answer below with tick or cross in yes, no or not known column, do not place NA in the columns.				
Probable Land Acquisition/Resettlement Effects	Yes	No	Not Known	Remarks
Temporary Use of Land				
Will the subproject need land for a diversion, camp, work yard or other requirement during construction period?		X		The plan Outlined confirmed to be followed
Will the temporary use of land require removal of crops and/or trees?	X			Removal of shrubs & trees of evasive species within Road Reserve
Will the temporary use of land create partial or full impacts on a main structure (house or commercial building)?		X		No Structures affected
Will the temporary use of land create impacts on livelihoods or income generating assets?		X		No impacts on income livelihood
Acquisition of Land				
1. Will there be land acquisition?		X		Within Road Reserve.
2. Is the site for land acquisition known?		X		Within Road Reserve
3. Is the ownership status and current usage of land to be acquired known?	X			Within Road Reserve
4. Will easement be utilized within an existing Right of Way (ROW)?	X			Within Road Reserve
5. Will there be loss of shelter and residential land due to land acquisition?		X		Clear Area. Within Road Reserve
6. Will there be loss of agricultural and other productive assets due to land acquisition?		X		Clear Area. Within Road Reserve
7. Will there be losses of crops, trees, and fixed assets due to land acquisition?		X		Clear Area. Within Road Reserve
8. Will there be loss of businesses or enterprises due to land acquisition?		X		Clear Area. Within Road Reserve
9. Will there be loss of income sources and means of livelihoods due to land acquisition?		X		Clear Area. Within Road Reserve
Restrictions on land use or on access				
10. Will people lose access to natural resources, communal facilities and services?		X		
11. If land use is changed, will it have an adverse impact on social and economic activities?		X		
12. Will access to land and resources owned communally or by the state be restricted?		X		
Information on Displaced Persons: There will be no Displacements of any Persons				
Any estimate of the likely number of persons that will be affected by temporary use of land during construction period [] No [] Yes If yes, approximately how many? _____ Any estimate of the likely number of persons that will be displaced by the Project? [] No [] Yes If yes, approximately how many? _____				
Category for resettlement impacts ¹ : A [] B [] C []				
Are any of them poor, female-heads of households, or vulnerable to poverty risks? [] No [] Yes				
Are any displaced persons from indigenous or ethnic minority groups? [] No [] Yes				

Annexure 2: Layout Plan



Annexure 3: Assessment Form

QRUP SECTION 5 - ENVIRONMENTAL ASSESSMENT CROSSCULVERT SLIP

Date	Common Name	Scientific Name	Qty	Locality	Image	Comments
Left towards Sigtaoka						
17.03.2	African Tulip (Pisipisi)	<i>Spathodea campanulata</i>	2	1		
	Yaqoyaqona	<i>Piper methysticum</i>	2	1		
	Rain Tree	<i>Samanea saman</i>	2	1		
	Areca palm	<i>Dyopsis lutescens</i>	1	1		

Annexure 4: Inspection Photos

